

PLANTA DE LOCAÇÃO DAS FUNDAÇÕES escala 1:50

DETALHAMENTO DAS SAPATAS

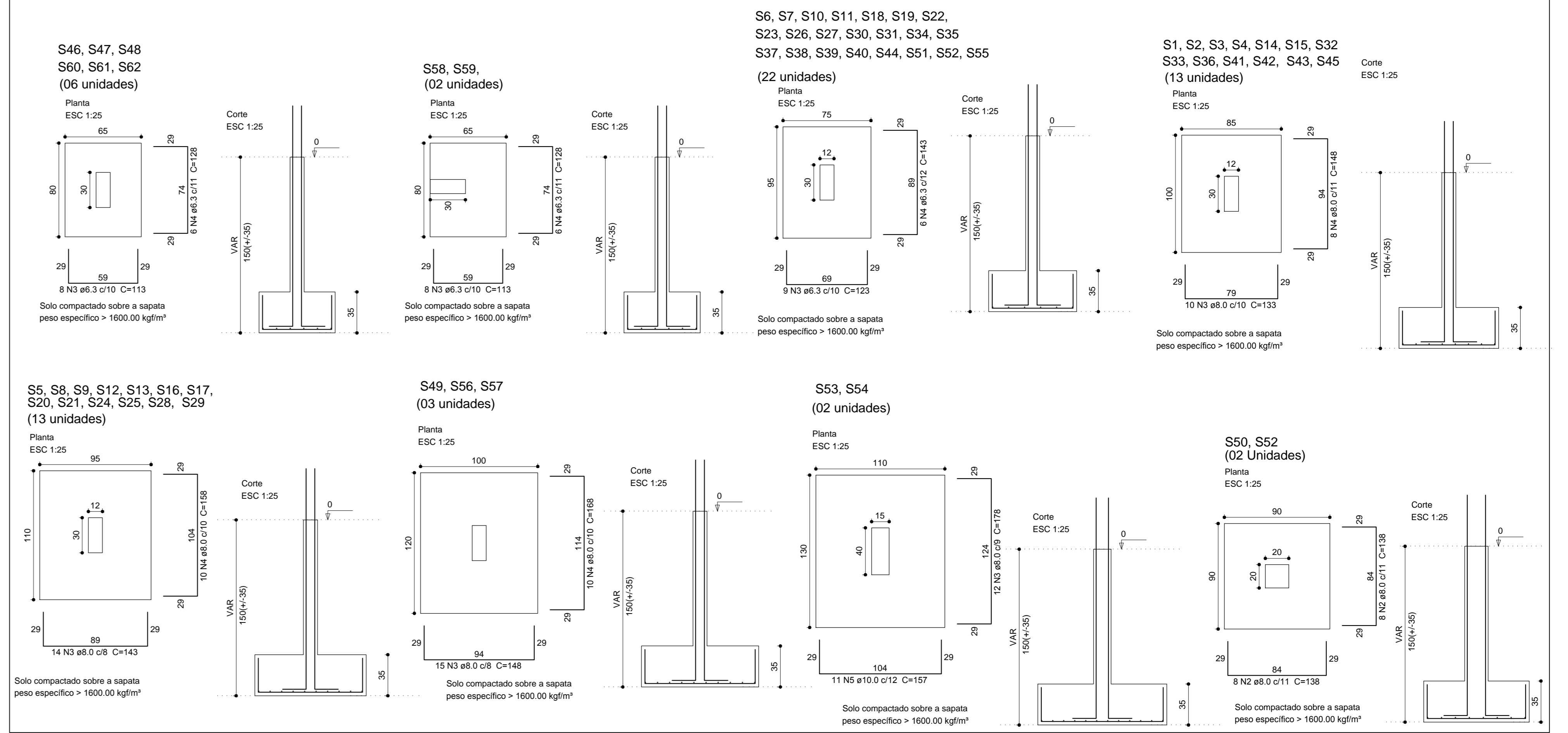

DETALHAMENTO DOS PILARES

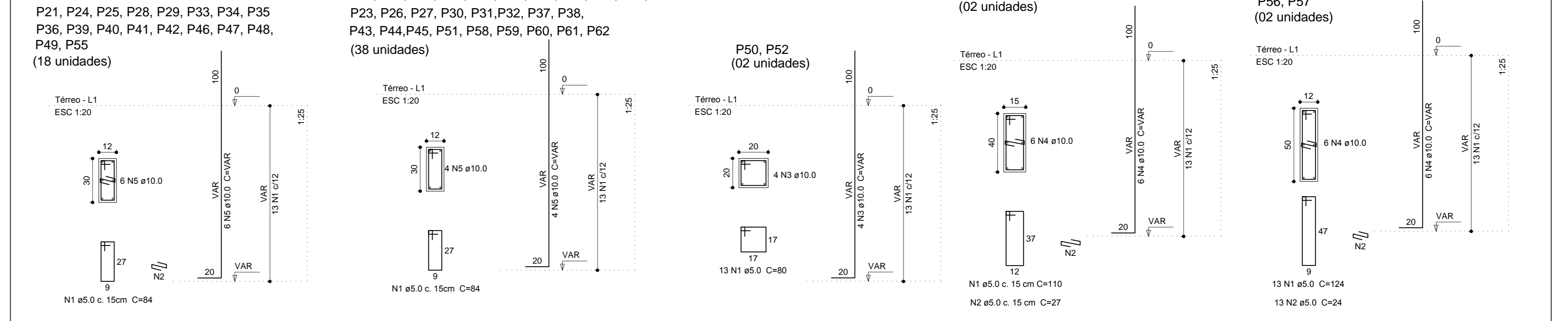

Nome	Seção	Pilar		Carga Máx. (t)	Carga Min. (t)	Fundação				
		X (cm)	Y (cm)			Lado B (d)	Lado H (cm)	H0 / ha (cm)	h1 / hb (cm)	d'
P1	12x30	95.50	2987.50	6.5	7.4	85	100	35	35	150
P2	12x30	482.50	2987.50	6.9	5.9	85	100	35	35	150
P3	12x30	647.50	2987.50	6.9	5.9	85	100	35	35	150
P4	12x30	1033.50	2987.50	7.4	6.5	85	100	35	35	150
P5	12x30	87.50	2692.50	7.7	6.7	95	110	35	35	150
P6	12x30	482.50	2692.50	6.7	4.8	75	95	35	35	150
P7	12x30	647.50	2692.50	5.8	3.8	75	95	35	35	150
P8	12x30	1042.50	2692.50	7.7	6.7	95	110	35	35	150
P9	12x30	87.50	2397.50	6.0	7.0	95	110	35	35	150
P10	12x30	482.50	2397.50	6.0	5.0	75	95	35	35	150
P11	12x30	647.50	2397.50	6.0	5.0	75	95	35	35	150
P12	12x30	1042.50	2397.50	8.0	7.0	95	110	35	35	150
P13	12x30	87.50	2102.50	7.8	6.8	95	110	35	35	150
P14	12x30	482.50	2102.50	6.8	5.8	85	100	35	35	150
P15	12x30	647.50	2102.50	6.8	5.8	85	100	35	35	150
P16	12x30	1042.50	2102.50	7.8	6.8	95	110	35	35	150
P17	12x30	87.50	1807.50	7.9	6.9	95	110	35	35	150
P18	12x30	482.50	1807.50	6.0	5.0	75	95	35	35	150
P19	12x30	647.50	1807.50	6.0	5.0	75	95	35	35	150
P20	12x30	1042.50	1807.50	7.9	6.9	95	110	35	35	150
P21	12x30	87.50	1512.50	7.9	6.9	95	110	35	35	150
P22	12x30	482.50	1512.50	6.0	5.0	75	95	35	35	150
P23	12x30	647.50	1512.50	6.0	5.0	75	95	35	35	150
P24	12x30	1042.50	1512.50	7.9	6.9	95	110	35	35	150
P25	12x30	87.50	1217.50	7.9	7.0	95	110	35	35	150
P26	12x30	482.50	1217.50	6.0	5.1	75	95	35	35	150
P27	12x30	647.50	1217.50	6.3	5.3	75	95	35	35	150
P28	12x30	1042.50	1217.50	8.2	7.2	95	110	35	35	150
P29	12x30	87.50	922.50	7.5	6.5	90	110	35	35	150
P30	12x30	482.50	922.50	4.9	4.0	75	95	35	35	150
P31	12x30	656.50	922.50	4.6	3.8	75	95	35	35	150
P32	12x30	1033.50	922.50	7.2	6.3	95	110	35	35	150
P33	12x30	1403.00	922.50	6.5	5.9	85	100	35	35	150
P34	12x30	1763.50	922.50	4.5	4.0	75	90	35	35	150
P35	12x30	1946.50	922.50	6.7	5.1	75	95	35	35	150
P36	12x30	2293.50	922.50	6.9	6.2	85	100	35	35	150
P37	12x30	482.50	747.50	5.3	4.3	75	95	35	35	150
P38	12x30	647.50	738.50	4.8	4.0	75	95	35	35	150
P39	12x30	1042.50	748.50	4.9	4.1	75	95	35	35	150
P40	12x30	1191.50	757.50	4.9	3.9	75	95	35	35	150
P41	12x30	1490.00	757.50	6.0	4.9	85	100	35	35	150
P42	12x30	1789.50	757.50	5.4	4.5	85	100	35	35	150
P43	12x30	87.50	486.00	5.8	4.9	85	100	35	35	150
P44	12x30	647.50	532.50	4.9	4.4	75	95	35	35	150
P45	12x30	847.50	532.50	5.5	4.8	100	120	35	35	150
P46	12x30	1042.50	541.50	4.0	3.7	65	85	35	35	150
P47	12x30	1812.50	583.50	4.1	3.4	65	85	35	35	150
P48	12x30	1937.50	601.50	3.6	3.0	65	85	35	35	150
P49	12x30	2302.50	515.00	10.9	9.4	100	120	35	35	150
P50	20x20	11.50	411.50	2.3	1.6	65	85	35	35	150
P51	12x30	95.50	407.50	5.0	4.3	75	95	35	35	150
P52	12x30	473.50	407.50	5.0	4.5	75	95	35	35	150
P53	15x40	1055.00	257.50	11.9	10.8	100	120	35	35	150
P54	15x40	1440.00	257.50	11.0	9.0	100	120	35	35	150
P55	12x30	1812.50	257.50	5.3	4.3	75	95	35	35	150
P56	12x30	1831.50	107.50	11.0	9.9	100	120	35	35	150
P57	12x30	2283.50	107.50	11.6	10.1	100	120	35	35	150
P58	12x30	219.50	3258.00	2.0	1.7	65	80	35	35	150
P59	12x30	359.50	3258.00	0.8	0.8	65	80	35	35	150
P60	12x30	368.50	3141.50	1.7	1.2	65	80	35	35	150
P61	12x30	647.50	3134.00	1.3	1.0	65	80	35	35	150
P62	12x30	219.50	2987.50	4.2	3.3	65	80	35	35	150

**VIRGINIA ROHENKOHL SILVA**  
ENG. CIVIL  
CREA - REGISTRO NACIONAL 2204383120

RUA ARLINDO LOPES DA SILVA N. 1456-W - TEL. 3326-1596

---

PROJETO: EDIFICAÇÃO INSTITUCIONAL

LOCAL: AV. DOS JAMBOS, PRAÇA TANCREDO DE ALMEIDA NEVES, QUADRA 03, LOTE 02, BAIRRO CENTRO, JUÍNA - MT

PROPRIETÁRIO: CÂMARA DE VEREADORES DE JUÍNA  
CNPE: 15.359.219/0001-59

---

ÁREAS: TERREIRO: 6.472,46 m<sup>2</sup>

A CONSTRUIR: 366,05 m<sup>2</sup>

PRESIDENTE: IVANI CARDOSO DALLA VALLE  
CÂMARA DE VEREADORES DE JUÍNA  
CNPE: 15.359.219/0001-59

---

VIRGINIA R. SILVA - AUTOR DO PROJETO  
ENG. CIVIL - CREA RN 2204383120

---

ESCALA: INCRIBADA

DATA: JULHO 2015

PRANCIA: PROJETO ESTRUCTURAL/ FUNDAÇÕES 01/05